

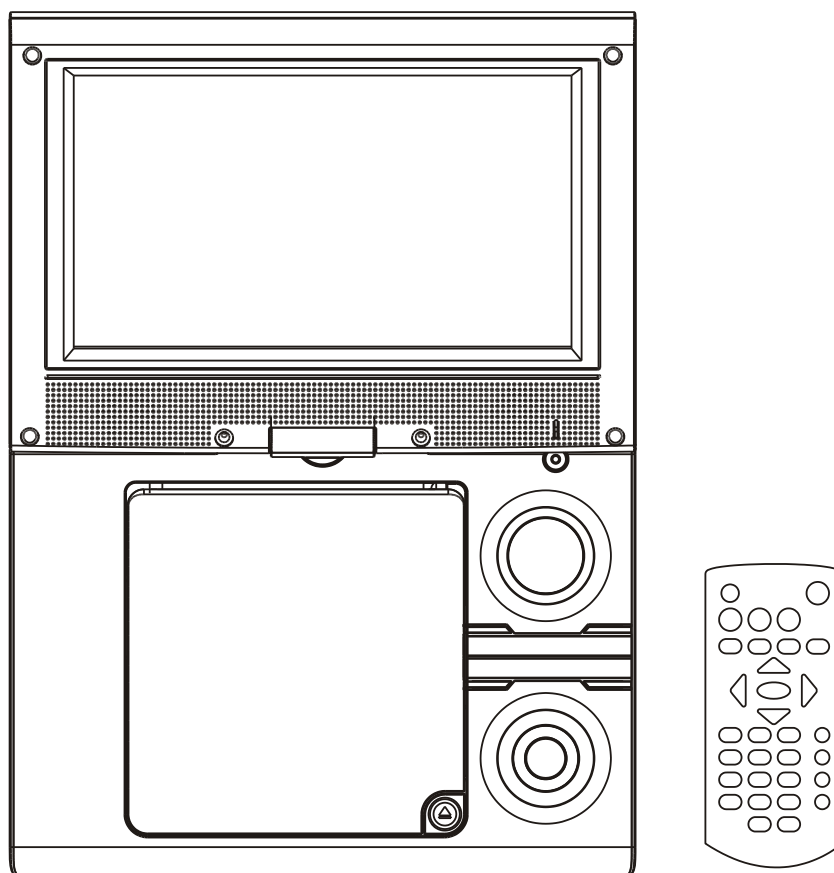

INSTRUCTION MANUAL

9" PORTABLE DVD PLAYER
with USB PORT & SD/MMC CARD READER

Model: PDV9900





WARNING

Before attempting to connect, operate or adjust this player, please read these instructions completely. Put this manual in a safe place for future reference.

WARNINGS

- To reduce the risk of fire or electric shock, do not expose this appliance to rain or moisture.
- To reduce the risk of electric shock, do not open the cabinet. No user serviceable parts are inside. Refer servicing to qualified personnel.
- This appliance uses a Laser System. To prevent direct exposure to the laser beam do not open the cabinet. Visible and invisible laser radiation is present when the cabinet is open. Avoid direct exposure and do not stare into the beam.
- Batteries should not be exposed to excessive heat such as direct sunlight, fire, or other heat sources.
- Caution: Do not expose this appliance to dripping or splashing liquids. Do not put objects filled with liquid, such as vases on or near the appliance.
- Caution: To turn this appliance off completely, the POWER cord must be unplugged from the wall outlet. The power cord must be easily accessible at all times.
- The rating label is located at the bottom of the apparatus.

 <p>THE LIGHTNING FLASH WITH ARROWHEAD SYMBOL, WITHIN AN EQUILATERAL TRIANGLE, IS INTENDED TO ALERT THE USER TO THE PRESENCE OF NON-INSULATED "DANGEROUS VOLTAGE" WITHIN THE PRODUCT'S ENCLOSURE THAT MAY BE OF SUFFICIENT MAGNITUDE TO CONSTITUTE A RISK OF ELECTRIC SHOCK TO PERSONS.</p>	<p>CAUTION</p> <p>RISK OF ELECTRIC SHOCK DO NOT OPEN</p> <p>WARNING: TO REDUCE THE RISK OF ELECTRIC SHOCK, DO NOT REMOVE THE FRONT OR REAR COVER. NO USER SERVICEABLE PARTS ARE INSIDE. REFER SERVICING TO QUALIFIED SERVICE PERSONNEL.</p>	 <p>THE EXCLAMATION POINT WITHIN AN EQUILATERAL TRIANGLE IS INTENDED TO ALERT THE USER TO THE PRESENCE OF IMPORTANT OPERATING AND MAINTENANCE (SERVICING) INSTRUCTIONS IN THE LITERATURE ACCOMPANYING THE APPLIANCE.</p>
--	--	---

FCC WARNINGS

WARNING: Changes or modifications to this unit not expressly approved in this manual could void the user's authority to operate the equipment.

NOTE: This equipment has been tested and found to comply with the limits for a Class B digital device, pursuant to Part 15 of the FCC Rules. These limits are designed to provide reasonable protection against harmful interference in a residential installation. This equipment generates, uses, and can radiate radio frequency energy and, if not installed and used in accordance with the instructions, may cause harmful interference to radio communications. However, there is no guarantee that interference will not occur in a particular installation. If this equipment does cause harmful interference to radio or television reception, which can be determined by turning the equipment off and on, the user is encouraged to try to correct the interference by one or more of the following measures:

- Reorient or relocate the receiving antenna.
- Increase the separation between the equipment and receiver.
- Connect the equipment into an outlet on a circuit different from that to which the receiver is connected.
- Consult the dealer or an experienced radio/TV technician for help.

IMPORTANT SAFETY INSTRUCTIONS

- 1) Read these instructions.
- 2) Keep these instructions.
- 3) Heed all warnings.
- 4) Follow all instructions.
- 5) Do not use this apparatus near water.
- 6) Clean only with dry cloth.
- 7) Do not block any ventilation openings. Install in accordance with the manufacturer's instructions.
- 8) Do not install near any heat sources such as radiators, heat registers, stoves, or other apparatus (including amplifiers) that produce heat.
- 9) Do not defeat the safety purpose of the polarized or grounding-type plug. A polarized plug has two blades with one wider than the other. A grounding type plug has two blades and a third grounding prong. The wide blade and/or the third prong are provided for your safety. If the provided plug does not fit into your outlet, consult an electrician for replacement of the obsolete outlet.
- 10) Protect the POWER cord from being walked on or pinched particularly at plugs, convenience receptacles, and the point where they exit from the apparatus.
- 11) Only use attachments/accessories specified by the manufacturer.
- 12) Use only with the cart, stand, tripod, bracket, or table specified by the manufacturer, or sold with the apparatus. When a cart is used, use caution when moving the cart/apparatus combination to avoid injury from tip-over.
- 13) Unplug this apparatus during lightning storms or when unused for long periods of time.
- 14) Refer all servicing to qualified service personnel. Servicing is required when the apparatus has been damaged in any way, such as POWER-supply cord or plug is damaged, liquid has been spilled or objects have fallen into the apparatus, the apparatus has been exposed to rain or moisture, does not operate normally, or has been dropped.



OVERVIEW OF THE DVD PLAYER

1. TFT SCREEN
2. SPEAKER
3. DISC COVER
4. PLAY/PAUSE BUTTON
5. PREVIOUS & F.REV BUTTON
6. SETUP BUTTON
7. VOL - BUTTON
8. DISC COVER OPEN BUTTON
9. NAVIGATION LEFT BUTTON
10. NAVIGATION DOWN BUTTON
11. REMOTE SENSOR
12. NEXT & F. FWD BUTTON
13. STOP & DVD/USB/CARD BUTTON
14. AUDIO BUTTON
15. VOL + BUTTON
16. NAVIGATION UP BUTTON
17. NAVIGATION RIGHT BUTTON
18. OK BUTTON
19. CHARGE INDICATOR
20. HEADPHONE JACK
21. POWER ON/OFF SWITCH
22. POWER INDICATOR
23. USB PORT
24. AV OUT JACK
25. SD/MMC CARD SLOT
26. DC IN JACK

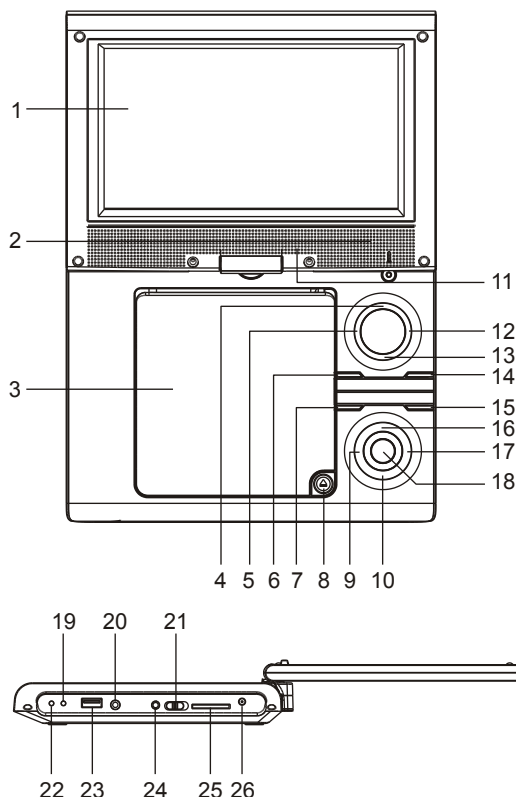

REMOTE CONTROL UNIT

1. SCREEN ON/OFF & BRI/COL button
2. TITLE button
3. MENU button
4. PREVIOUS & F.REV button
5. NEXT & F.FWD button
6. NAVIGATION UP button
7. NAVIGATION LEFT button
8. OK/PLAY/PAUSE button
9. NUMERIC buttons
10. PROGRAM/ANGLE button
11. VOLUME- button
12. MUTE button
13. SETUP button
14. DISPLAY button
15. STOP/SOURCE button
16. NAVIGATION RIGHT button
17. NAVIGATION DOWN button
18. SUBTITLE button
19. AUDIO button
20. SEARCH button
21. REPEAT button
22. ZOOM/SLOW button
23. VOLUME+ button

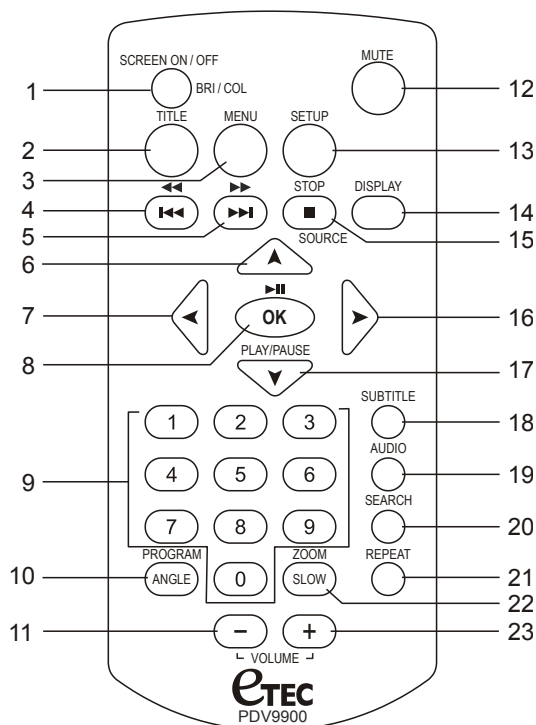

CONNECT DVD PLAYER TO OTHER APPLIANCES

- It is recommended you connect the player to a multi-system TV.
- Ensure that this player and other appliances (TV set and amplifier) that will be connected to the player are set to OFF mode and that the AC cords are disconnected from the wall outlet.
- Avoid blocking ventilation holes of the connected appliances and make sure air around there can circulate freely.
- Read carefully and follow the instructions before connecting other appliances.
- Ensure that you observe the color coding when connecting audio, video cables. If the RCA adapter is supplied only, the audio/video RCA cable is required. Plug one end of the RCA adapter to the unit. Then connect the audio/video RCA cable to the RCA adapter and the television.

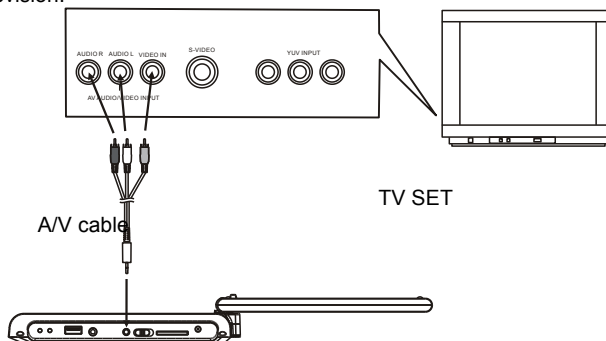

After connection is firmed and securely done, plug AC ADAPTER to an applicable wall outlet and turn on the player.

CHARGE THE BUILT-IN BATTERY

The player is with a rechargeable lithium battery. Before using the battery, please make sure it is charged. If not, charge it first. Slide the power switch to OFF position and then connect one end of the supplied adapter to the wall outlet and the other end to the unit for charging the built-in battery.

Note:

1. The battery only could be charged at powering off mode.
2. If the unit is not in use for a prolonged period of time, it is recommendable to charge the built-in battery each three months.

CONNECTING TO A CAR ADAPTOR

The car power adaptor is designed for use with vehicles that have a 12V, negative ground electrical system.

WARNING:

Disconnect the car power adaptor when not in use. Not in use in 24V vehicles.

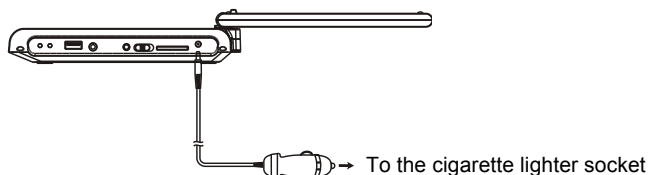

CAUTIONS:

- Use the unit only with the recommended car power adaptor, use with other car power adaptor might damage the unit.
- The recommended car power adaptor is for use with this unit only. Do not use it with other equipment.
- In the interests of road traffic safety, do not operate the unit or view video software while driving a vehicle.
- Make sure the unit is fastened securely to prevent from moving outside of the vehicle in an accident
- When the inside of the cigarette lighter socket is dirty with ashes or dust, the plug section may become hot due to poor contact. Be sure to clean the cigarette lighter socket before use.
- After use, disconnect the car power adaptor from both the unit and cigarette lighter socket.

FUSE REPLACEMENT

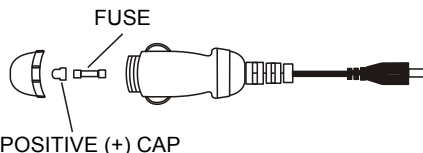

NOTE: Don't throw out the positive (+) cap when replace the fuse.

OPERATIONS

PREPARATION

Power on the TV set and select video input mode.

Power on the audio system which is connected to the player.

GET STARTED

1. Slide POWER switch to turn on the player.
2. Press DISC cover open key to open the disc tray.
3. Place a disc onto the disc tray

4. Close the disc tray and the playback starts automatically.
5. When a menu screen appears on the TV, press the navigation buttons or press the numeric buttons to select a preferred track number, then press OK button to start playback.

ADJUSTING THE VOLUME

Press **VOLUME+** button to increase the volume. Press **VOLUME-** button to decrease the volume.

MUTE

When the player is on, the audio output player is shut off by pressing the **MUTE** button. Press it again to resume audio output.

SKIP AHEAD OR BACK

Press **PREV** button during play to skip previous chapter (DVD) or a track (CD), Press **NEXT** button during play to skip next chapter (DVD) or a track (CD).

RAPID ADVANCE/REVERSE

During playback, press and hold **F.FWD** button or **F.REV** button to scan the disc forward or backward at X2, X4, X8, X20 normal speed.

Press **PLAY** button to resume normal play.

STOP PLAYBACK

Press **STOP** button during playback to stop playback; the player activates its resume function when **STOP** is pressed in STOP mode; press **PLAY/PAUSE** button again, playback resumes at the point it stopped previously; open the disc tray or press the **STOP** button one more time to clear the resume function.

Press and hold **STOP** button to make selection among Disc, card and USB.

SLOW-MOTION PLAY (DVD)

Press and hold **SLOW** button during playback, the disc will be played at 1/2 normal speed at first, each time this button is pressed, the play speed becomes slower (down to 1/7 normal speed.)

Press **PLAY/PAUSE** button, normal play will resume.

REPEAT

Press **REPEAT** button during play, it will repeat play one chapter/title or repeat all (for DVD disc), or repeat play a track or all tracks (for CD), or repeat the sections between two specific points (A-B).

BRIGHTNESS AND COLOR ADJUSTMENT

Press **SCREEN ON/OFF** button repeatedly to adjust the screen brightness and color respectively via navigation right/left button. Press and hold **SCREEN ON/OFF** button to turn on/off screen.

SEARCH FOR PREFERRED SCENE

1. Press **SEARCH** button during play and highlight the item to be played (Title, Chapter, or Chapter time) by navigation buttons.
2. Input the desired number or time via the numeric buttons.
3. Press **OK** button to confirm and the playback from the located scene starts.
4. To exit search menu, press **SEARCH** button directly.

PROGRAM PLAY (UP TO 16 MEMORIES)

1. Press **PROGRAM** during playback to display the program menu.
2. Select location(s) to be memorized via navigation buttons and then enter desired Titles/Chapters numbers via numeric buttons.
Example: Track 3, press "3"
Track 12, press "1" and then "2"
Track 21, press "2" and then "1"
3. To start programmed playback, select **PLAY** on the menu; press **PROGRAM** button again to exit programming.
4. To change programmed items, scroll the navigation button to the item to be changed and enter the desired track number on the screen, the selected item will be changed. To clear all items, select the <CLEAR> on the menu, and then press OK button on remote control.
5. You can also cancel program mode by clearing all the items in the program menu.

ZOOM PLAY – Note: Only ZOOM enabled DVDs will operate with this function

Press **ZOOM** button continuously to zoom in the picture by 2,3, and 4 times, zoom out by 1/2,1/3,1/4 normal size.

Press this button once more when the picture is at 1/4 size to return to the normal size display.

Scroll to view the enlarged picture using Navigation buttons.

ON SCREEN DISPLAY INFORMATION

When the player is in operation, press **DISPLAY** button continuously, the screen will display parts of information (current disc type, title number, chapter number, playtime, audio language, audio type, subtitle language and multi angle, etc.) in a sequence.

CHANGING AUDIO SOUNDTRACK LANGUAGE NOTE: Only multi-language enabled DVDs will operate with this function

It is possible to change the audio soundtrack language to a different language from the one selected at the initial settings (This operation works only with discs on which multiple audio soundtrack languages are recorded).

Press **AUDIO** button during DVD disc play, the sound track will be changed with a selected sound track showing on the screen.

NOTE: Only multi-language enabled DVDs will operate with this function.

MULTI-ANGLE VIEWING – Note: Only multi-angle enabled DVDs will operate with this function.
Press and hold **ANGLE** button to select your desired angle to view the scene.

CHANGING SUBTITLE LANGUAGE -Note: Only multi-subtitle enabled DVDs will operate with this function.
Press **SUBTITLE** button several times during DVD playback, the subtitle language will be changed with the a selected subtitle language showing on the screen; when the desired language appears, release the button to view the subtitle in that language.

RETURN TO MAIN MENU AND PLAY THE TITLE (DVD)

During playback, press **MENU** button to return to main menu and press **TITLE** button to play the title.

PICTURE CD / JPEG CD PLAYBACK

1. Load a picture CD/JPEG CD disc onto the disc tray, then select the picture option on the media menu to play the disc with navigation left/right button and press **OK** Button to confirm.
2. Slide show of Picture CD begins automatically;
3. Folders of the JPEG picture CD are displayed on the TV screen; use the navigation buttons on the remote to select the desired folder and then press **OK** button to confirm.
4. The files in this folder are displayed and you can select your favorite pictures using the up/down navigation buttons on the remote and press **OK** button to start playback.
5. Preview of the picture and corresponding information of the picture (includes resolution, size, date) will be displayed while you scroll across the file names.

PICTURE CD / JPEG CD OPERATIONS

1. PLAY MODES

Press **REPEAT** button to change play mode.
During playback, press **STOP** to enter preview mode.

2. SKIP TO NEXT/PREVIOUS PICTURE

Press **NEXT** button to skip to the next picture or **PREV** button to the previous picture.

3. PICTURE ROTATIONS

Press **RIGHT** and **LEFT** navigation buttons to rotate the picture clockwise and anti-clockwise respectively.

4. PICTURE FLIP AND TURN

Press **UP** navigation button to flip the picture up or down.
Press **DOWN** navigation button to flip the picture left or right.

5. PICTURE ZOOM IN/OUT

Press **ZOOM** button continuously, the picture zooms in by 2, 3, 4 times or zooms out by 1/2, 1/3, 1/4 the original size.
Press this button once more when the picture getting 1/4 size to return to the normal play.
If the picture is enlarged, you may use the navigation buttons to view blocked parts of the picture.

6. SLIDE SHOW TRANSITION MODES

During slide show playback, press the **PROGRAM** button cyclically to select one play transition effect to play picture.

EXTERNAL MEMORY MEDIA OPERATION (USB & SD/MMC CARD)

External Memory Media Operation

1. Slide the **POWER** switch to **ON** position and insert a USB drive or a SD/MMC Card filled with media files into the USB port/Card Reader. When the USB or the SD/MMC card is successfully detected and read, a media menu will show on the screen. Select a corresponding media file/type to play using the navigation **RIGHT/LEFT** buttons and press **OK** button to confirm and the unit will start playing from the first file of the selected folder.

2. Press **NEXT** or **PREVIOUS** button to skip forward or backward.

Note: Press and hold **STOP** button to make selection among USB, SD Card and disc via navigation **RIGHT/LEFT** buttons and press **OK** button to confirm.

CAUTION: To avoid electronic static discharge, don't touch the USB port or SD Card slot during playback.

INITIAL SETTINGS

Initial settings page is for you to make your preferred settings up for your player. Once the initial settings are done they are retained in the player memory until otherwise modified.

COMMON PROCEDURES FOR INITIAL SETTINGS

1. Press **SETUP** button to access the setup menu.
2. Use the navigation buttons to select the item you want to modify, setting page with further setting items displayed shows on the TV screen. Again use navigation buttons to make changes. Press **OK** button to confirm modifications.
3. Use navigation buttons to switch to another setting on the main setting page.
4. Press **SETUP** button to exit main setting page.

1. SYSTEM SETUP

1.1 TV SYSTEM - it is used to select the TV mode.

Please select this option as per your TV set.

1.2 SCREEN SAVER - when the player is not in used for several minutes, a running DVD logo will move across the TV screen to protect the TV screen.

Options:

On: Screen saver is enabled

Off: Screen saver is disabled

1.3 TV TYPE - it is used to select the TV scan mode, please set as per your TV set.

Options: 4:3PS : Normal Pan & scan mode

4:3LB : normal Letterbox mode

16:9 : 16:9 wide screen mode

1.4 PASSWORD - input password to unlock the system. The steps are as follows:

1.4.1 Enter SYSTEM SETUP, select the PASSWORD item by scrolling the down navigation button, and then press the right navigation button to select the input box.

1.4.2 Input user's password "0000" to unlock it, in this case, select the input box again to change the password by inputting another new four numeric numbers and then press OK button to confirm. When the password is changed, you are needed to input the new one to unlock the system.

1.4.3 Once you forget your own password, use the supervisor's password "8200" to unlock it.

NOTE: If wrong password was input in unlock status, the system will lock.

1.5 RATING - Set the rating of this player. If you want to change the rating of parental lock, please input the password to unlock first.

Options: 1 KID SAFE / 2 G / 3 PG / 4 PG 13 / 5 PG-R/ 6R / 7 NC-17 / 8 ADULT

1.6 DEFAULT - Reset to factory settings.

Options: RESTORE

2. LANGUAGE SETUP

2.1 OSD LANGUAGE - to select a different On Screen Display language for different user.

2.2 AUDIO LANG - select preferred audio language.

(DVD only, need disc software support)

2.3 SUBTITLE LANG - Select preferred subtitle language.

(DVD only, need disc software support)

2.4 MENU LANG - Select preferred disc menu language.

(DVD only, need disc software support)

3. VIDEO SETUP

3.1 BRIGHTNESS - to set the brightness for the display.

Options: 0/2/4/6/8/10/12

3.2 CONTRAST - to set the contrast effect for display.

Options: 0/2/4/6/8/10/12

3.3 HUE - to set the color impression for display.

Options: -6/-4/-2/0/+2/+4/+6

3.4 SATURATION - to set the saturation level for display.

Options: 0/2/4/6/8/10/12

4. SPEAKER SETUP

4.1 DOWNMIX

Options: LT/RT - Left/Right mix mode

STEREO - Select this option if you don't have a 5.1 channels amplifier.

TROUBLESHOOTING

If your DVD player does not seem to be functioning properly, check the items below before you contact an authorized service center.

Symptom	Check
Power does not turn on or suddenly turns off.	<ul style="list-style-type: none">• Make sure the adapter is securely plugged in.• Turn the power off and then back on.
Battery pack is in place but the power does not turn on or suddenly turns off.	<ul style="list-style-type: none">• Check that the battery pack is charged. If not, recharge it.
Remote control doesn't work	<ul style="list-style-type: none">• Check that the battery is inserted in the "+" and "-" direction properly.• The battery may be flat. Replace it with a new one.• Check that the signal transmission is directed at the remote control sensor on the DVD player.• Remove the obstacle between the remote controller and remote control sensor.
No picture or sound	<ul style="list-style-type: none">• Check that the A/V cables are securely connected.• Check that the disc is a DVD, DVD-RW or AUDIO CD.• Do not use a disc that has scratches or dirt.• Check that the label-side of the disc is facing up.• The pick-up lens of the DVD player may be dirty. Contact the service center for lens cleaning.• Check that the TV channel is set to VIDEO or AV if viewing with a TV.
No picture	<ul style="list-style-type: none">• Check that the LCD display is turned on.
No sound	<ul style="list-style-type: none">• Check that the display panel is open. If it is closed, audio will not be output to the speakers.• Check the volume setting. If set to zero, turn up volume level.• Check that the headphones are plugged into the PHONES socket. Speakers cannot be used with the headphones.
No picture and sound	<ul style="list-style-type: none">• Check that the adapter is properly connected.
Distorted video or sound	<ul style="list-style-type: none">• Use a disc without scratches or dents.



LIMITED 90-DAY WARRANTY

We warrant this product to be free from defects in material and workmanship under normal use for a ninety-day period from the original date of purchase from an authorized ETEC dealer.

Should you be missing any of the included accessories or other components (screws, pieces, etc.), please contact the Customer Support Center to secure a replacement. It is not necessary to bring the unit back to the store. When calling, please reference the parts list found in the Instruction Manual to help us accurately identify the missing parts and promptly provide replacements.

We will replace the unit free of charge should it become defective under this warranty, providing you, the original purchaser, have your original dated sales receipt.

To obtain warranty service or replacement within the ninety-day warranty period, please return the product with all parts and accessories along with your original dated store receipt to the original place of purchase and the unit will be exchanged at no charge. It is not necessary to contact the manufacturer for warranty replacement.

Our Customer Support Center is available Monday - Saturday (10:00AM to 7:00PM EST) for technical assistance or troubleshooting. To contact us, please call 1-855-994-3832.

This warranty applies only under conditions of normal use. Our products are not intended for outdoor use.

There are no consumer serviceable parts contained in this product and any attempt by the owner to service or repair the unit will immediately void all warranty coverage.

This warranty does not cover any product which has been subject to damage due to an act of nature, misuse, neglect, accident, abuse, commercial use, or modification of, or to, any part of the product, including the antenna. Damage to any external media such as DVD & CD discs, and/or USB or other memory devices are not covered nor is the cost incurred in shipping the unit for warranty repair or exchange. Under no circumstances shall ETEC be liable for any loss (direct, indirect, incidental, foreseen, unforeseen, special or consequential) or for any damage arising out of, or in connection with, the use of this product.

UNDER NO CIRCUMSTANCES WILL ETEC BE LIABLE FOR ANY INCIDENTAL OR CONSEQUENTIAL DAMAGES.

This warranty does not cover re-manufactured, refurbished, or repaired units, or any products sold 'As Is'.

This warranty is valid only to the original purchaser of the Product in the United States and Canada and grants specific legal rights.