

Tilting, Swiveling & Rotating Flat Panel Wall Mount Installation Guide

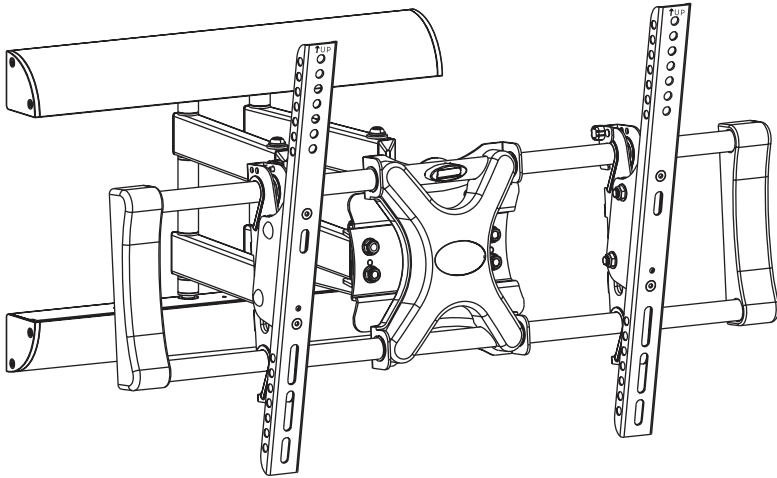

Model: V5665STS



- Easy installation
- Low profile
- Built-in level for easy positioning
- Safety locks secure the TV on the mount
- Easy to adjust tilt angles: +5 to -15 degrees
- +5 to -5 degree rotation adjustment
- 90 degree left to right swivel range



E331265

- Supports most 32"- 80" Flat Panel TVs
- Maximum weight capacity: 132 lbs.
- Supports VESA Sizes up to 600X400

**For technical assistance or troubleshooting
please call 1-855-998-4326.**



This product Wall Mount frame is intended for use only with an apparatus which has a maximum weight of 132 lbs. See apparatus instructions. Using with an apparatus heavier than the maximum weight indicated may result in instability and cause possible injury.

READ THIS FIRST

Read this entire manual! Do not attempt to install this product if you do not understand the instructions. Contact a qualified mount installer if you have any doubts about a safe and secure mount installation, or if you are not sure what specific wall materials you are attaching this mount to. Check all the parts carefully to make sure there are no missing or damaged parts. Improper installation may result in damage to your TV, property, and personal injury.



This product is intended only to mount a television of the indicated size and weight. Using this product to mount televisions heavier than the maximum weight capacity can damage equipment and cause personal injury.

Schoenfeld International Inc. and VIDAIO are not responsible for personal injury or product damage due to mishandling, incorrect mounting, incorrect assembly, or incorrect use of this product.



CHILD SAFETY

How and where you use your television wall mount is extremely important for Child Safety. As you set up and use your new product, keep all of these safety tips in mind.

- One size of TV wall mount does not fit all TVs. Use only a TV wall mount rated for the weight of your TV and the size of your screen. Your TV wall mount assembly instructions contains specific information on the maximum weight and screen size combination that your wall mount can safely support. Do not exceed the maximum weight of screen size for any TV wall mount.
- Carefully read all of enclosed instructions for proper use of this product. If you have any doubts about safe and secure assembly, please contact a professional.
- Don't let children climb on or play with mounts or TVs.
- Remember that children can become excited while watching a program, especially on a "larger than life" TV. Make sure to place or install the TV wall mount where it cannot be pushed, pulled on, or knocked down.
- Make sure that you route all cords and cables so that they cannot be pulled or grabbed by curious children.



Always wear safety goggles to when drilling or installing hardware.

Tools

For your convenience, we have included an allen wrench and a socket tool with this mount. For the best assembly experience and mounting safety, we always recommend using full-size tools for each assembly steps.

Below is a recommended tool list you will need for proper and safe installation. See applicable warnings in this manual about certain types of mounting surface materials and the special hardware and tools that should be used.

- Drill with a specific size drill bit to pre-drill holes in the wall
- Stud finder
- Tape measure
- Pencil
- Screw drivers
- Socket wrenches
- Small hammer
- Safety goggles

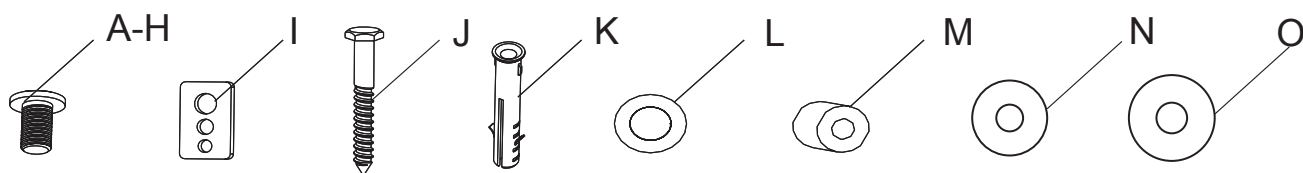
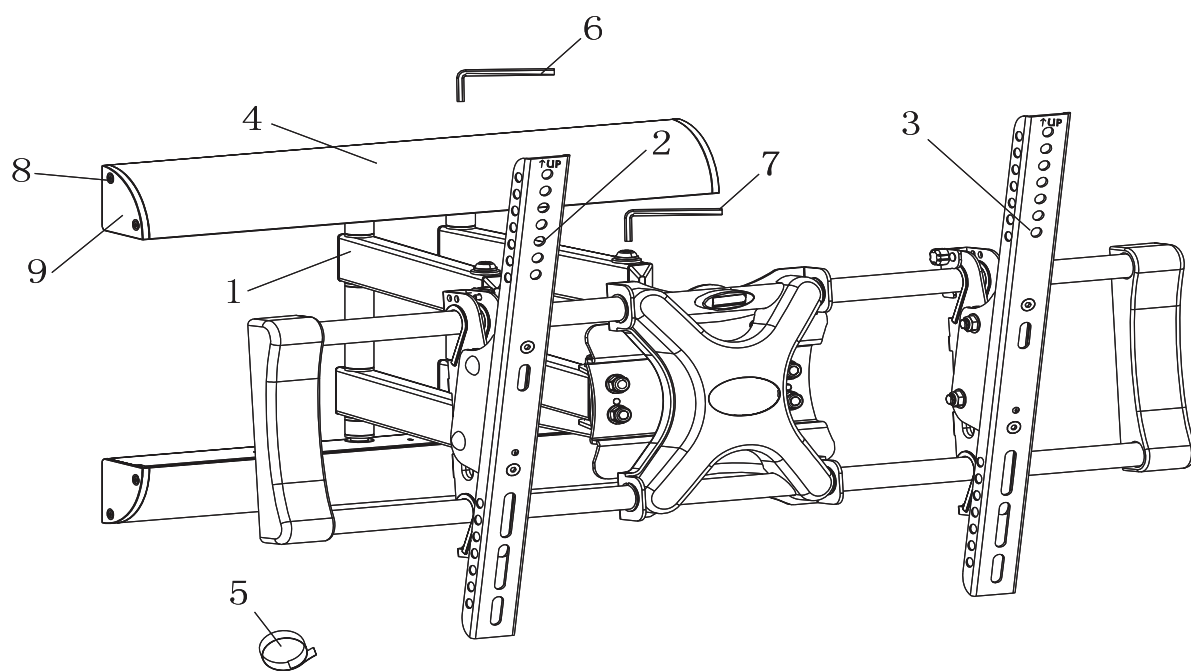

ID	Qty	Description
1	1	Arm assembly
2	1	Left bracket
3	1	Right bracket
4	2	Plastic covers
5	3	Cable management clips
6	2	6mm allen wrench
7	2	5mm allen wrench
8	8	Tapping screws
9	4	Plastic side covers
A	4	M4x20mm bolts
B	4	M4x30mm bolts
C	4	M5x20mm bolts

ID	Qty	Description
D	4	M5x30mm bolts
E	4	M6x25mm bolts
F	4	M6x40mm bolts
G	4	M8x25mm bolts
H	4	M8x45mm bolts
I	4	Square washer
J	6	Long bolts
K	6	Wall anchors
L	6	Long bolt washers
M	4	Spacers
N	4	M4/M5 washers
O	12	M6/M8 washers

The actual appearance and quantity of parts may be different than shown in the illustration. Consult the table for actual quantities.

Step 1: Attach the left and right brackets to your TV



Do not force the bolts into the mounting holes on your TV. Do not use an electric drill to tighten these bolts on your TV. This could damage the equipment or cause personal injury.

CAUTION: Do not place the TV face down on a hard surface when installing the mounting plate on the TV. Placing the TV face down on a hard surface can result in equipment damage. Use a blanket or other suitable surface.

Check your TV manual to confirm the required bolt diameter according to the size, depth, and position of the mounting holes in your TV.

For correct installation, install the brackets with the hook on each bracket facing down

Install the bolts, spacers, and square washers in accordance with the following:

If your television has a straight back, spacers are not required. Use the selected bolts (A-H) and square washers (I) to install the bracket directly on the back of the television as shown in Fig 1a. Make sure that the two brackets are equal in height and are level. Once the brackets are aligned, securely tighten the bolts. If necessary, use additional washers (N, O) to make sure the bolts (A-H) keep the bracket snug to the rear of the TV without over tightening.

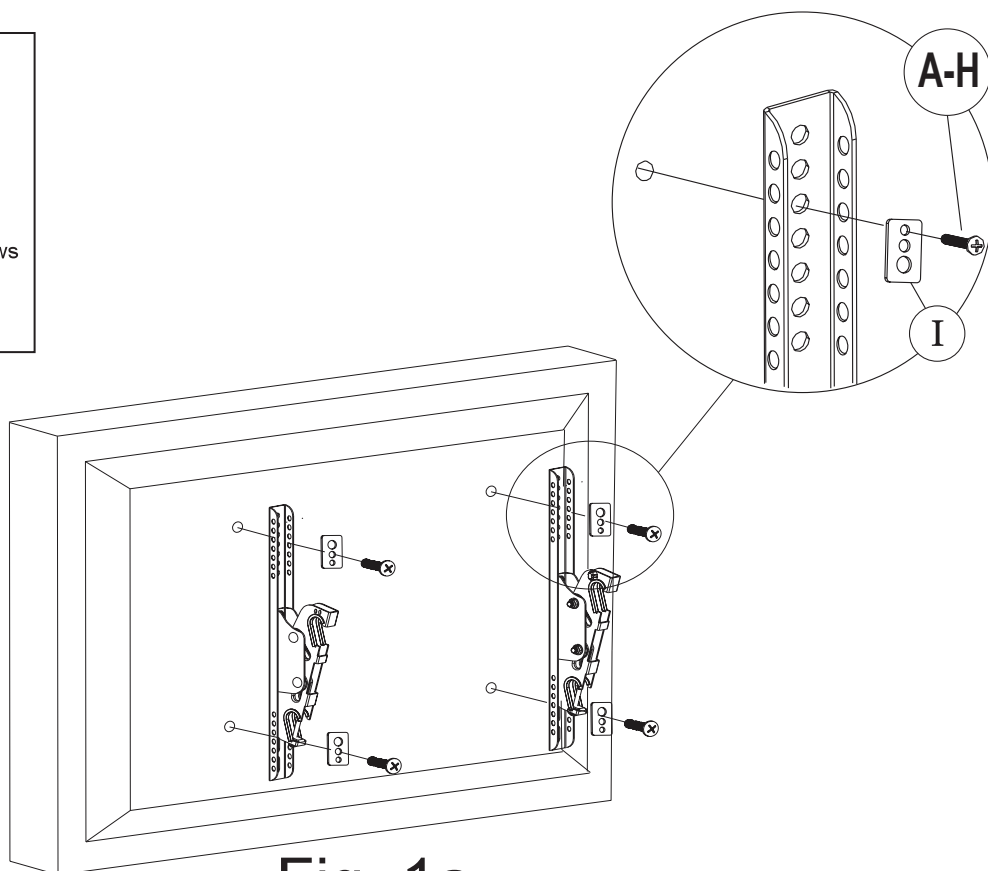
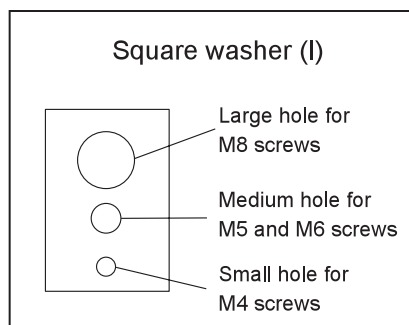

Fig. 1a

If your television has a curved back and mounting holes are recessed (Fig 1a), spacers are required. Install the spacers (M) between the display and the bracket as shown in Fig 1b. Then use the selected bolts (F-H) and square washers (I) to install the brackets with spacers to the back of the television. Make sure that the two brackets are equal in height and are level. Once the brackets are aligned, securely tighten the bolts (Fig 1b). If necessary, use additional washers (N, O) to make sure that the bolts (F-H) keep the bracket snug to the rear of the TV without over tightening.



Fig. 1a

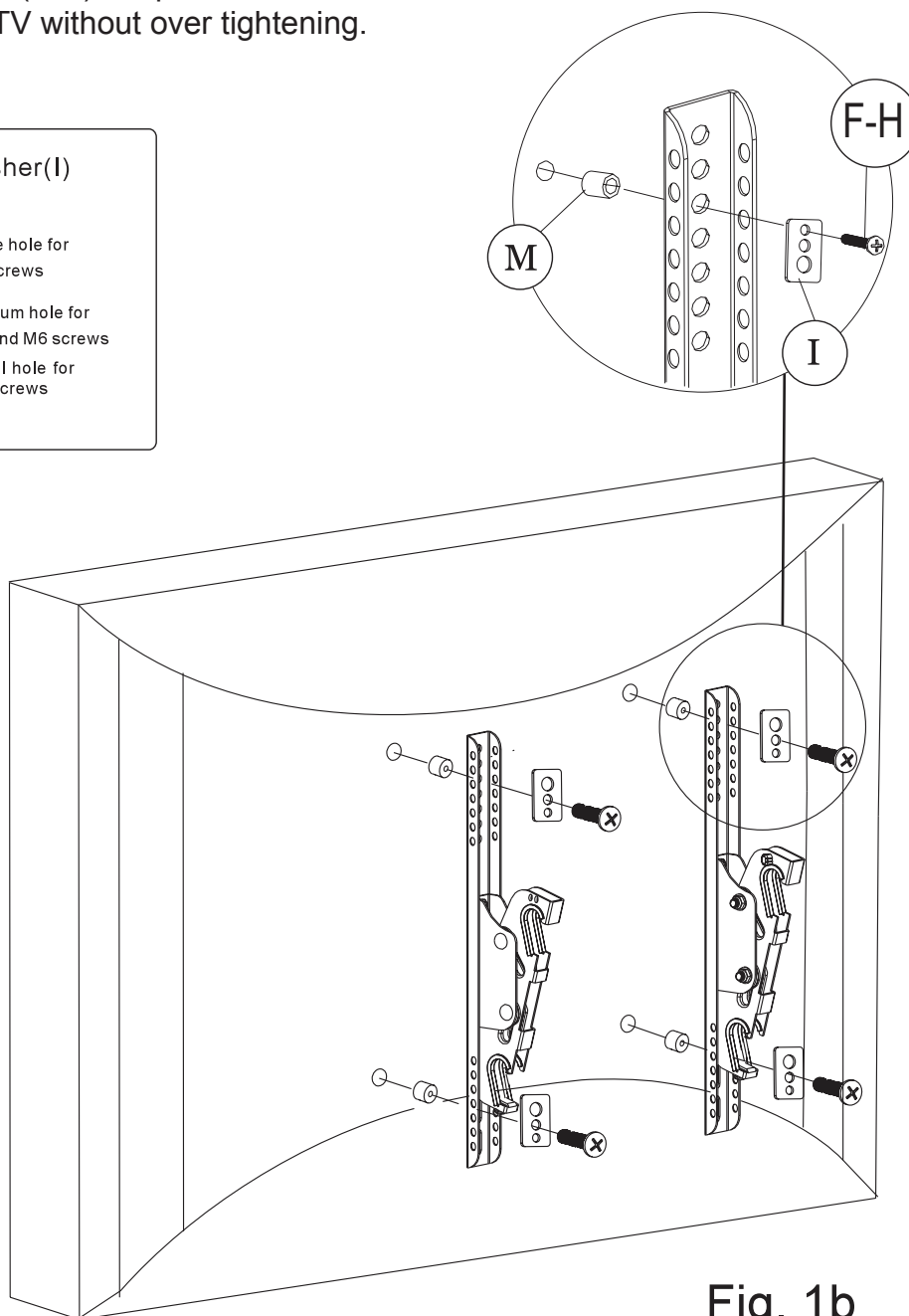
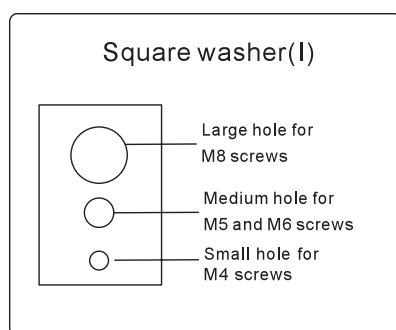

Fig. 1b

Step 2: Find and mark the best position for the wall mount on the wall.

The best viewing height is parallel to the eye level of a person sitting on a couch. Normally, this is about 4 feet above floor level.

In addition to your eye level height when you are seated, the following two measurements will help you determine the perfect height for your wall-mounted television (Fig 2):

- The distance from your viewing location to the wall.
- The vertical distance from eye level to the floor plus the distance from your viewing location to the wall when the viewing angle is 15 degrees.

For example:

- If distance 'a' is 5 to 7 feet (1.5 to 2.1 meters), distance 'b' is about 1 foot (0.3 meter)
- If distance 'a' is 8 to 13 feet (2.4 to 4 meters), distance 'b' is about 3 feet (0.9 meter)
- If distance 'a' is 14 to 17 feet (4.3 to 5.2 meters), distance 'b' is about 4 feet (1.2 meters)

Add the eye level height plus 'b' to get the ideal height of the center of the television display.

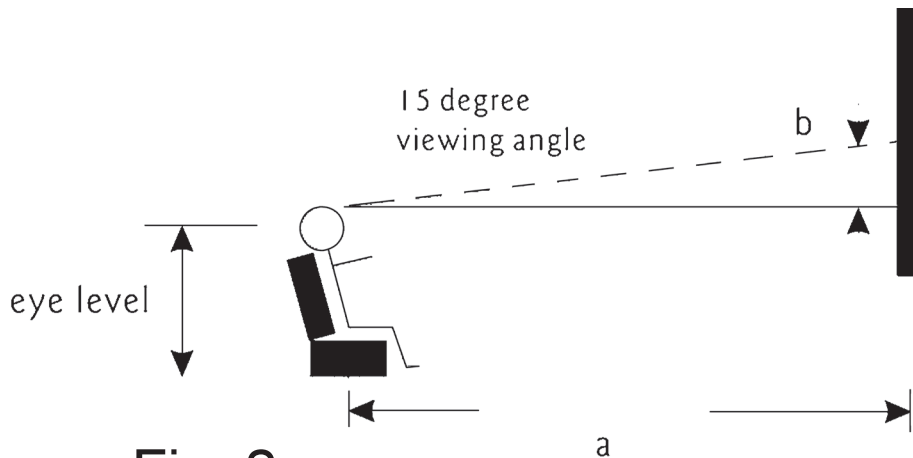

Fig. 2

Step 3: Attach the wall mount to the wall

After determining the ideal height on the wall for your television, follow the mounting instructions for your type of wall construction: wood stud or concrete walls.



Attaching this mount to wood studs or concrete walls requires special tools and hardware to ensure the mount is securely and safely attached to these materials. Concrete will break or crumble if special masonry drill bits and drill operating speeds are not properly used. Consult a professional if you are unsure or have any doubts about the safety of the installation. Personal injury or equipment damage can result if the mount is not properly installed.

Wood stud walls (Fig 3a)

1. Use a pencil, awl, or a nail to mark the location of the wall stud centers (Fig 3b) after locating the stud with an electronic stud locator. The distance between marks should not be less than 16 inches (Studs must not be less than 16 inches (40.6 cm)).
2. Place the wall mount flat against the wall with the center of the mount in the desired location, aligning the holes in the mount with the studs (Fig 3c). Use the wall plate as a template to mark the location of all four mounting holes on the wall. Make sure that the mounting holes are level and are parallel.
3. Use 3/16" (5mm) drill bit to pre-drill holes at least 2" inches (50mm) deep at the marked locations.
4. Use a wrench, the four long bolts (J), and washers (L) to attach the wall mount to the wall. Do not use wall anchors in wood stud walls.
5. Use the magnet level placed on the front of the mounting plate to level the wall mount, repositioning as necessary, then securely tighten the bolts.

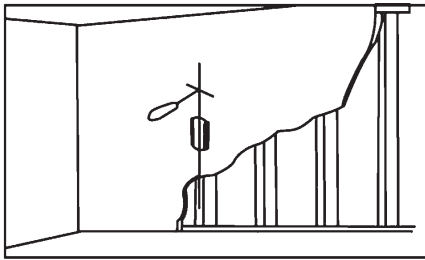

Fig. 3b

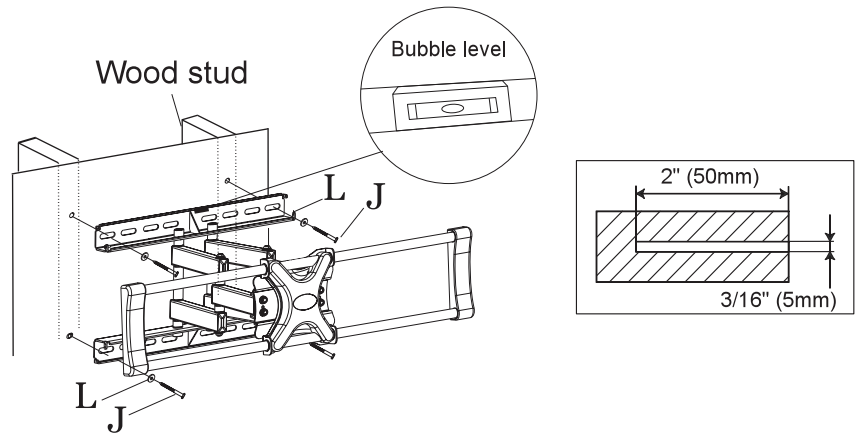

Fig. 3c

Concrete Walls:

1. Place the wall mount flat against the wall in the desired location. Use the wall plate as a template to mark the location of all six mounting holes on the wall. Make sure that the mounting holes are level and are parallel. The distance between marks should not be less than 16 inches (Studs must not be less than 16 inches (40.6 cm)).
2. Use 3/8" (10mm) drill bit to pre-drill six holes at least 2" inches (50mm) deep (Fig 3d) at the marked locations.
3. Insert a wall anchor (K) into each pre-drilled hole and lightly tap it with a hammer until the wall anchor is flush with the wall.
4. Use a wrench, the six long bolts (J), and washers (L) to attach the wall mount to the wall with the wall anchors (Fig. 3e).
5. Use the magnet level placed on the front of the mounting plate to level the wall mount (Fig 3e), repositioning as necessary, then securely tighten the bolts.

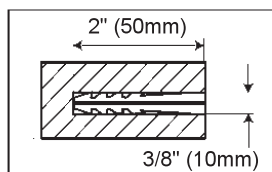

Fig. 3d

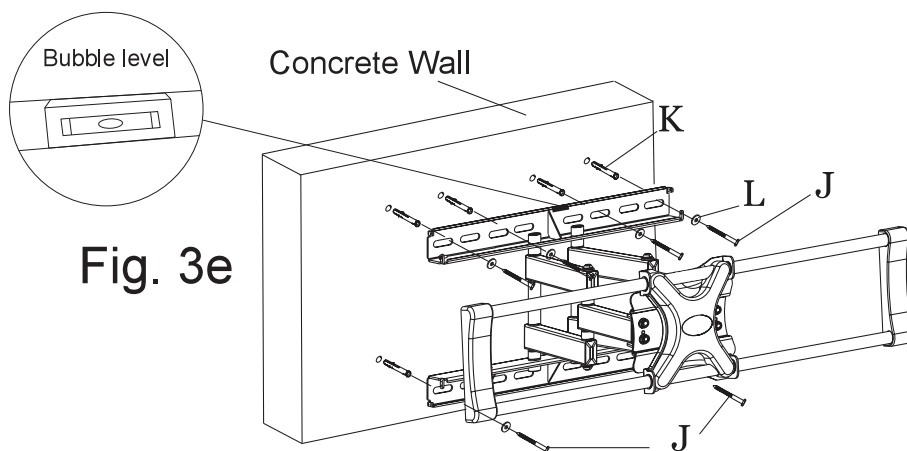

Fig. 3e

Step 4-Attaching plastic cover wall plate

Secure plastic cover over wall plate by pushing them toward each other until they lock in place.

Use tapping screws (8) to attach side plastic covers (9) to plastic cover (4).

Do not over tighten (Fig.4a).

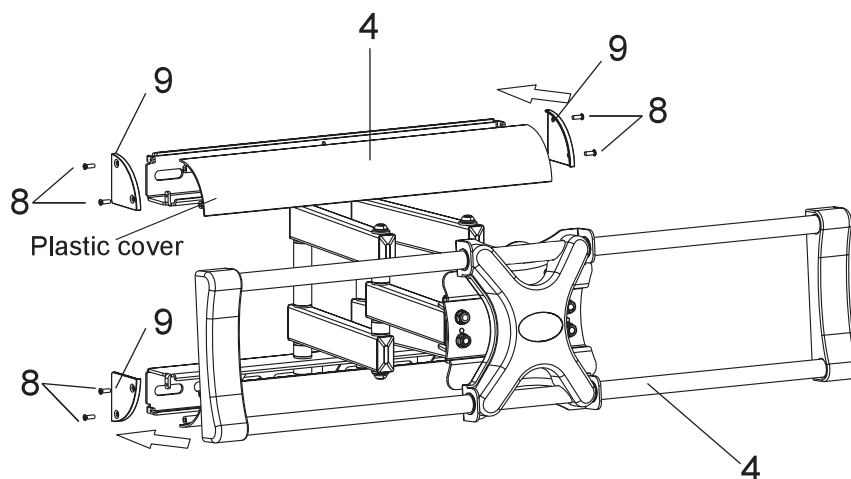

Fig. 4a

Step 5: Hang the television display



A large television requires two people to lift. Schoenfeld International Inc. and VIDA0 are not responsible for equipment damage or personal injury due to mishandling.

Do not release the TV until you are sure that it is securely mounted. Releasing the TV without first ensuring that it is securely installed can result in equipment damage or personal injury.

1. Prior to lifting the display, make sure that the safety lock is in the open position as shown in (Fig. 5a & 5b).
2. Lift the television display with the brackets securely attached to the wall mount.
3. Hook the top of brackets over the top bar of the wall mount (Fig. 5b).
4. Rotate the display to let the brackets hook over the bottom bar of the mount. Close the safety locks to secure the display as shown in (Fig. 5c).

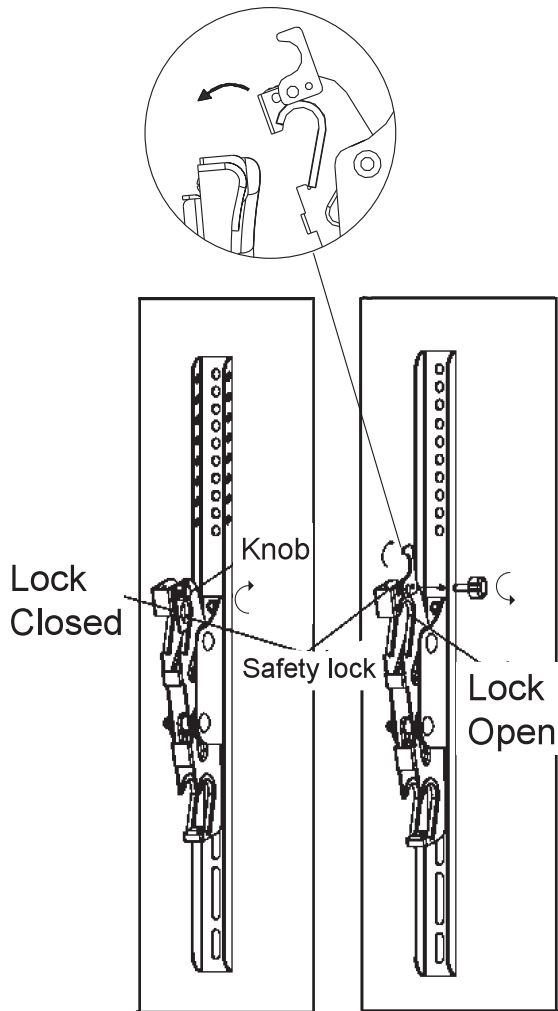

Fig. 5a

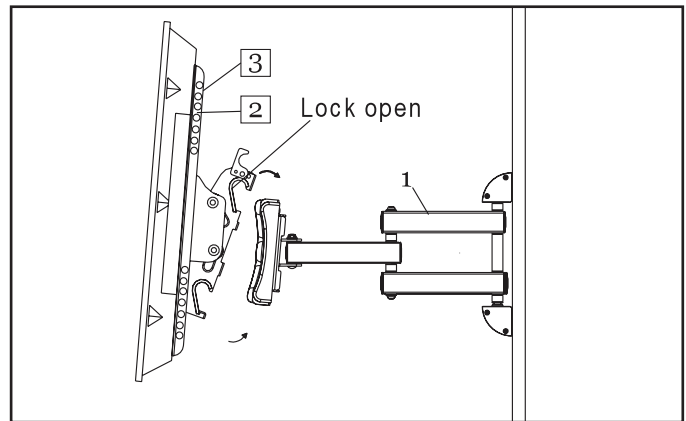

Fig. 5b

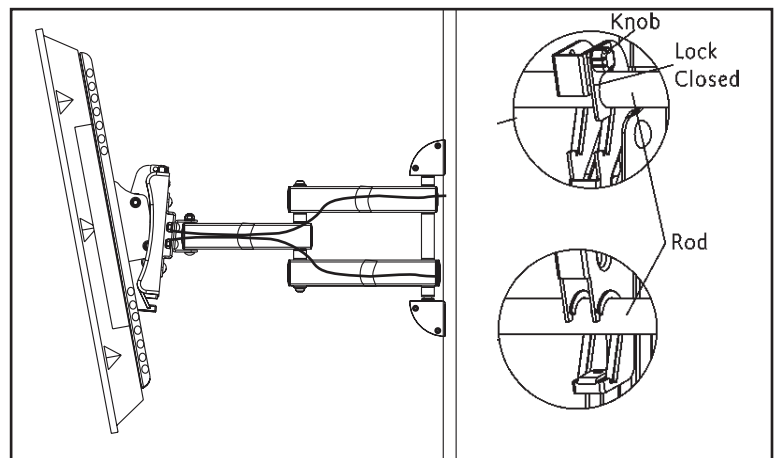

Fig. 5c

Step 6: Adjusting the tilt angle

This patented design features an unique tilt angle mechanism that can easily be adjusted by just one person. No tools are required for this step. As shown in Fig. 6a, grasp the top and bottom of the mounted flat panel and gently pull the top of the flat panel toward you or back to adjust the viewing angle.



Fig. 6a

In some cases depending on the weight of your TV, the bracket angle tension may require a one-time adjustment.

After mounting, if the TV does not stay in your preferred viewing angle there is not enough tension on the two screws found on the inner side of each “angle-free” bracket. Follow the six steps below to adjust (tighten) the tension of the bracket screws to prevent this issue.

1. Carefully remove the TV from the wall mount bars and place the screen face down on a flat surface that is clean and without objects of any kind. The rear of the flat panel with the “angle-free” mount brackets attached is facing upward towards the ceiling.
2. Use a regular slotted screwdriver to remove the four black rubber screw “caps” found on the inner side of each bracket.
3. Use the Box wrench (6) to tighten all four of these nuts (two nuts on each bracket) 1/4 turn to the right. After tightening, replace the black plastic caps over each screw.
4. Carefully lift up the TV and properly attach the brackets to the mount bar and secure the safety latches
5. Adjust the “angle-free” tilt to your proper viewing position and without letting go of the TV, lessen your hand pressure to see if the angle tilt is properly held in place by the mount. If additional tension is still required, repeat steps 1 – 5. Do not over-tighten these nuts or the “angle-free” tilt adjustment will not function at all.
6. Once the proper tension is achieved, replace the black rubber caps on the exposed ends of the screw/nuts

Adjusting the display (Fig. 6b)

This mount provides a wealth of adjustment to offer the best viewing from any seated position (Fig. 6b)

Left to right pan adjustment

The display can pan 90 degrees from left to right. Choose the desired position and use the provided wrench to tighten the front bolt on the top of the Arm Assembly to secure.

Left to right swivel adjustment

The display can swivel 90 degrees from left to right. Choose the desired position and use the provided wrench to tighten the back bolt on the top of the Arm Assembly to secure.

Rotation adjustment

The display can rotate $+5^{\circ}$ to -5° degrees

Flattening the display to the wall

Grasp the side edges of the display, swivel and pull the display into the center position. Push the display straight back towards the wall into the flattened position. Note: Use care when flattening the display to insure that cables do not become pinched.

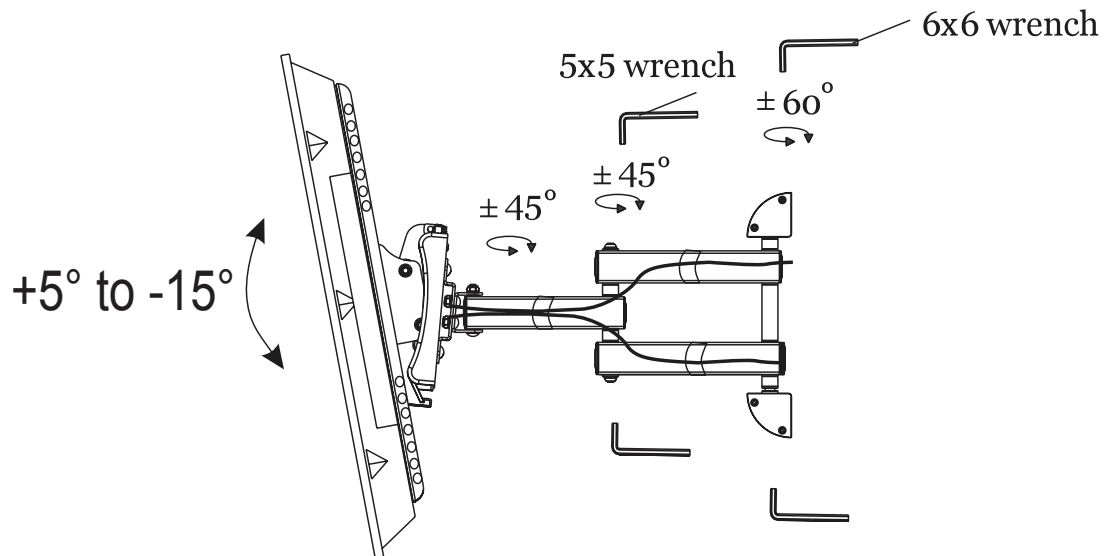

Fig.6b



LIMITED SIX-YEAR WALL MOUNT WARRANTY

We warrant this product to you, the original purchaser at the time of purchase printed on a dated store receipt from an authorized VIDAO retailer and for a period of six-years thereafter that our wall mount product and all its parts and components are free of defects in material and workmanship under normal use. This warranty is subject to the provisions below. VIDAO's sole obligation and the purchaser's exclusive remedy pursuant to these warranties are limited to replacement at VIDAO's sole discretion. There are no other warranties except as expressly set forth below either expressed or implied, including any warranty of merchantability for any particular purpose.

Should you be missing any of the assembly parts or components (screws, pieces, etc.), please contact the Customer Support Center to secure a replacement. It is not necessary to bring the unit back to the store. When calling, please reference the parts list found in the Instruction Manual to help us accurately identify the missing parts and promptly provide replacements.

Our Customer Support Center is available Monday to Saturday (10:00AM to 7:00PM EST) for technical assistance or troubleshooting. To contact us please call 1-855-998-4326.

This warranty is expressly limited to the replacement of wall mount parts and components described in the parts list located in the Instruction Manual included with the product.

This warranty applies under conditions of normal use.

This warranty does not cover: any product, which has been subject to damage due to improper assembly or disassembly, products which were not assembled, installed, used, or maintained in accordance with the product assembly instructions & warnings, acts of nature, misuse, neglect, accidents, abuse, exposure to elements, outdoor use, extreme temperature ranges, damage during transit, commercial use, modification of, or to any part of the product or attachments to the product not approved by VIDAO. Also not covered are costs for assembly/dis-assembly labor, costs incurred in shipping the unit or parts for warranty repair/exchange or any products purchased from unauthorized VIDAO sellers. Under no circumstances shall VIDAO, be liable for any loss (direct, indirect, incidental, foreseen, unforeseen, special or consequential) or for any damage arising out of, or in connection with, the use of this product. Nor shall VIDAO have any responsibility for incidental or consequential damages resulting from the breach of this warranty including but not limited to inconvenience, purchase or rental of replacement products, loss of profits or commercial loss.

We reserve the right to request damaged parts or units be shipped to our offices for inspection or confirmation of any warranty claims.

This warranty does not cover product sold 'As Is'.

This warranty is valid only to the original purchaser of the Product in the United States and Canada and grants specific legal rights.

Schoenfeld International Inc. and VIDAO

5001 American Boulevard West
Suite 275
Bloomington, MN 55437

©Schoenfeld International Inc. 2013
PN: V5665STS Rev 1.4V October, 2013